

WATERPROOF R3C FEMALE

2.6/50S CABLE

R197.115._11

Series : SMB CARLOCK

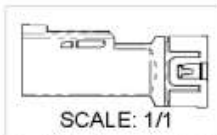
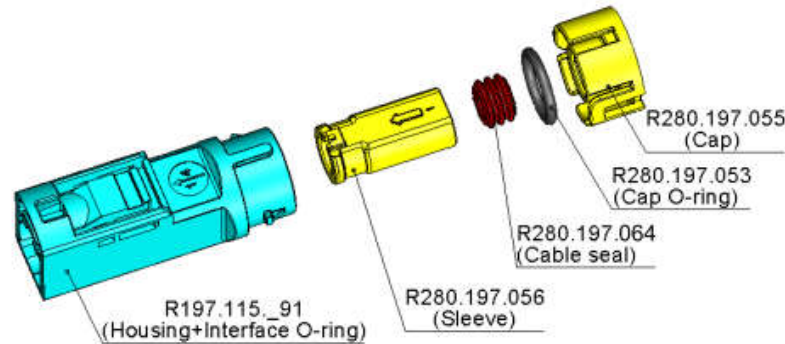
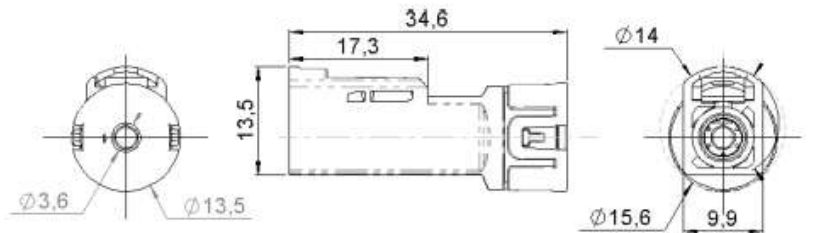

To obtain the complete P/N please fill in the blank "_" with the coding letter
Coding Z is shown for information

All dimensions are in mm.

COMPONENTS	MATERIALS	UL CLASSIFICATION	COLOR	PACKAGING
INTERFACE O-RING	SILICON		RED	In bulk on cardbox / Qty: 3000
HOUSING	POLYAMIDE	UL 94 V-2	See Page2	
SLEEVE	POLYAMIDE	UL 94 V-2	YELLOW	In bulk on cardbox / Qty: 16000
CABLE SEAL	SILICON		RED	In bulk on cardbox / Qty: 50000
CAP O-RING	HNBR		BLACK	In bulk on cardbox / Qty: 24000
CAP	POLYAMIDE	UL 94 V-2	YELLOW	In bulk on cardbox / Qty: 14000

Mating life **25** Cycles mini Operating temperature **-40/+105 °C**
Weight **3.33** g Waterproof level **IP67**

Note: IP67 guaranteed with connector R299.197.200 and RG174 cable only. Waterproof only guaranteed with a waterproof Plug.

Issue : 1630A

In the effort to improve our products, we reserve the right to make changes judged to be necessary.



WATERPROOF R3C MALE

2.6/50S CABLE

R197.135._11

Series : SMB CARLOCK

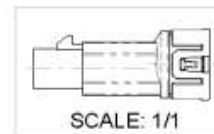
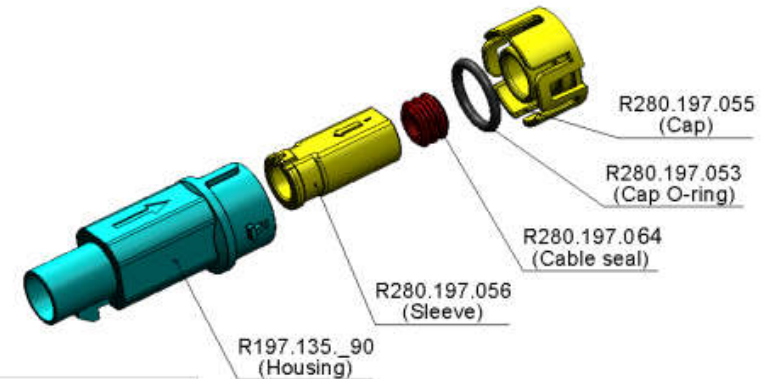
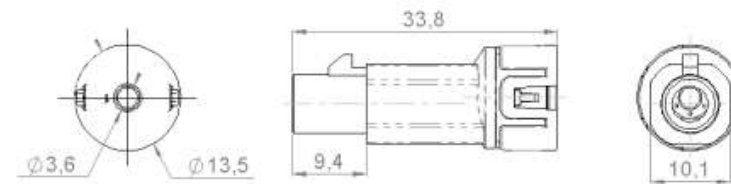

To obtain the complete P/N please fill in the blank "_" with the coding letter
Coding Z is shown for information

All dimensions are in mm.

COMPONENTS	MATERIALS	UL CLASSIFICATION	COLOR	PACKAGING
HOUSING	POLYAMIDE	UL 94 V-2	See Page2	In bulk on cardbox / Qty:3000
SLEEVE	POLYAMIDE	UL 94 V-2	YELLOW	In bulk on plastic bag / Qty:16000
CABLE SEAL	SILICON		RED	In bulk on plastic bag / Qty:50000
CAP O-RING	HNBR		BLACK	In bulk on plastic bag / Qty:24000
CAP	POLYAMIDE	UL 94 V-2	YELLOW	In bulk on plastic bag / Qty:14000

MECHANICAL CHARACTERISTICS

Mating life **50** Cycles mini
Weight **2.62** g

ENVIRONMENTAL

Operating temperature **-40/+105 °C**
Waterproof level **IP67**

Note: IP67 guaranteed with connector R299.197.000 and RG174 cable only. Waterproof only guaranteed with a waterproof Jack.

Issue : 1630A

In the effort to improve our products, we reserve the right to make changes judged to be necessary.

